

DISTRICT	COUNTY	ROUTE	SECTION	SHEET
8-0	ADAMS	T-438	---	1 OF 4
GERMANY TOWNSHIP				
REVISION NUMBER	REVISIONS	DATE	BY	APPROVED

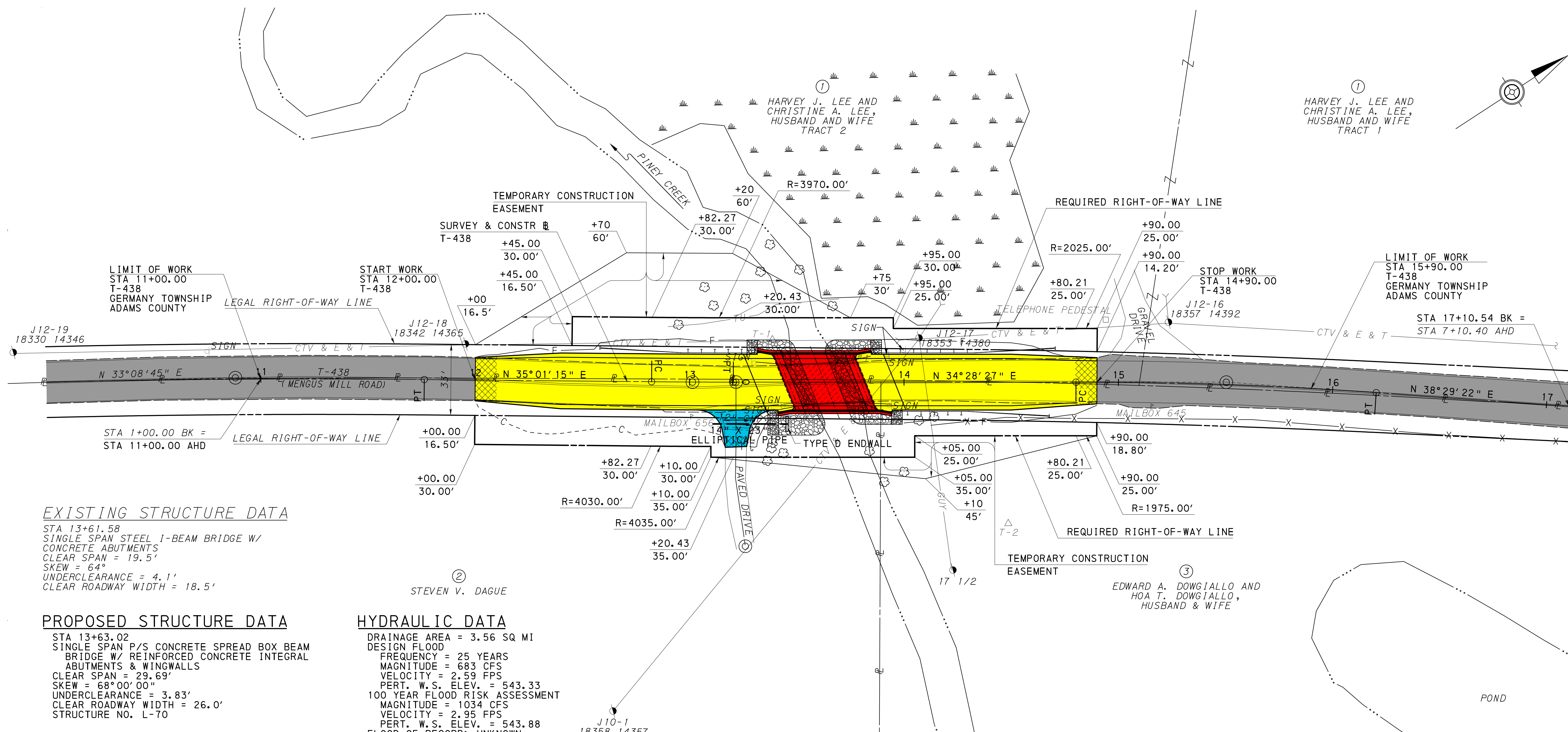

**EXISTING STRUCTURE DATA**

STA 13+61.58  
 SINGLE SPAN STEEL I-BEAM BRIDGE W/  
 CONCRETE ABUTMENTS  
 CLEAR SPAN = 19.5'  
 SKEW = 64°  
 UNDERCLEARANCE = 4.1'  
 CLEAR ROADWAY WIDTH = 18.5'

**PROPOSED STRUCTURE DATA**

STA 13+63.02  
 SINGLE SPAN P/S CONCRETE SPREAD BOX BEAM  
 BRIDGE W/ REINFORCED CONCRETE INTEGRAL  
 ABUTMENTS & WINGWALLS  
 CLEAR SPAN = 29.69'  
 SKEW = 68°00'00"  
 UNDERCLEARANCE = 3.83'  
 CLEAR ROADWAY WIDTH = 26.0'  
 STRUCTURE NO. L-70

**HYDRAULIC DATA**

DRAINAGE AREA = 3.56 SQ MI  
 DESIGN FLOOD  
 FREQUENCY = 25 YEARS  
 MAGNITUDE = 683 CFS  
 VELOCITY = 2.59 FPS  
 PERT. W.S. ELEV. = 543.33  
 100 YEAR FLOOD RISK ASSESSMENT  
 MAGNITUDE = 1034 CFS  
 VELOCITY = 2.95 FPS  
 PERT. W.S. ELEV. = 543.88  
 FLOOD OF RECORD: UNKNOWN



- LEGEND**
- PROPOSED ROADWAY
  - PROPOSED STRUCTURE
  - PAVED DRIVE
  - EXISTING STRUCTURE TO BE REMOVED
  - PARCEL IDENTIFICATION NUMBER
  - PARCEL IDENTIFICATION NUMBER - NO TAKE

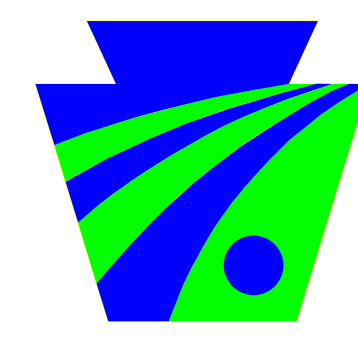

**pennsylvania**  
 DEPARTMENT OF TRANSPORTATION

**PRELIMINARY  
 DRAWING  
 OR  
 INFORMATION**  
 This drawing and/or information shall be used for reference purposes only, as details and content are subject to change.



DISTRICT	COUNTY	ROUTE	SECTION	SHEET
8-0	ADAMS	T-438	---	3 OF 4
GERMANY TOWNSHIP				
REVISION NUMBER	REVISIONS	DATE	BY	APPROVED

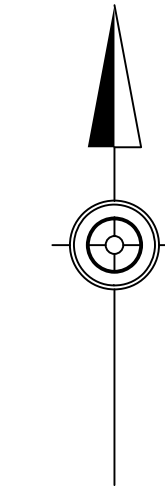
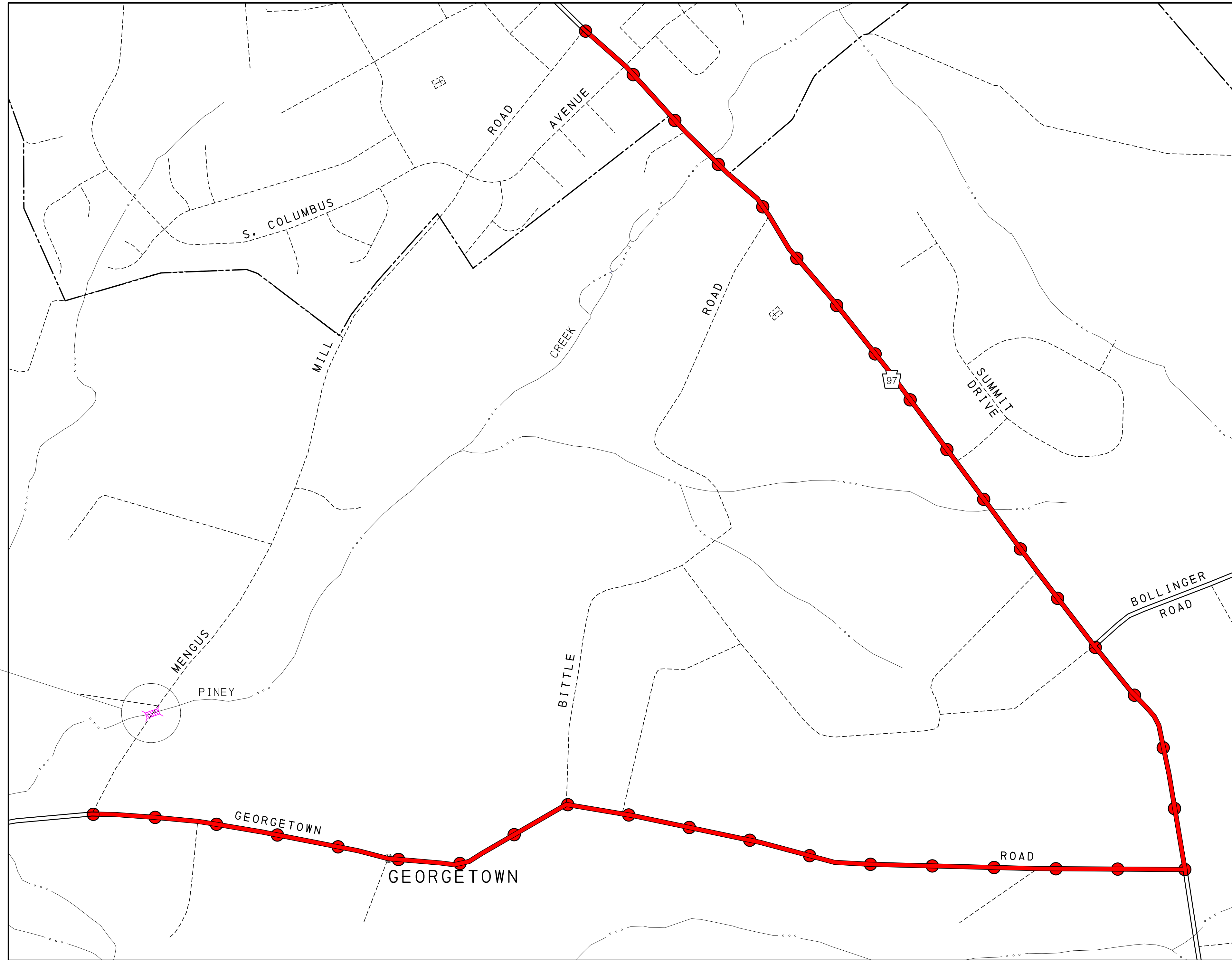

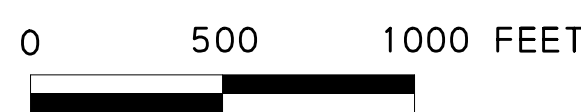

PROJECT LOCATION

DETOUR MAP

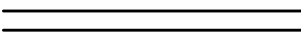
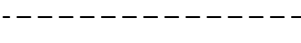

**LEGEND**

-  PROJECT
-  STATE HIGHWAY
-  TOWNSHIP ROAD
-  DETOUR

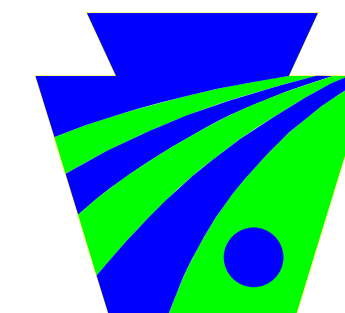

**pennsylvania**  
DEPARTMENT OF TRANSPORTATION

*PRELIMINARY  
DRAWING  
OR  
INFORMATION*

This drawing and/or information shall be used for reference purposes only, as details and content are subject to change.

TITLE: 5486-052P - ADAMS COUNTY ROUTE 97 - GERMANY TOWNSHIP  
 DATE: 4/3/18  
 DRAWN BY: CBH  
 CHECKED BY: DG  
 DESIGNED BY: CAU  
 PROJECT NO: 5486-052P  
 PROJECT LOCATION: ROUTE 97, GERMANY TOWNSHIP, ADAMS COUNTY, PENNSYLVANIA  
 CLIENT: PENNSYLVANIA DEPARTMENT OF TRANSPORTATION  
 PROJECT NO: 5486-052P

